

## Donington Park – MG Car Club race meeting on Sunday 28<sup>th</sup> August 2011

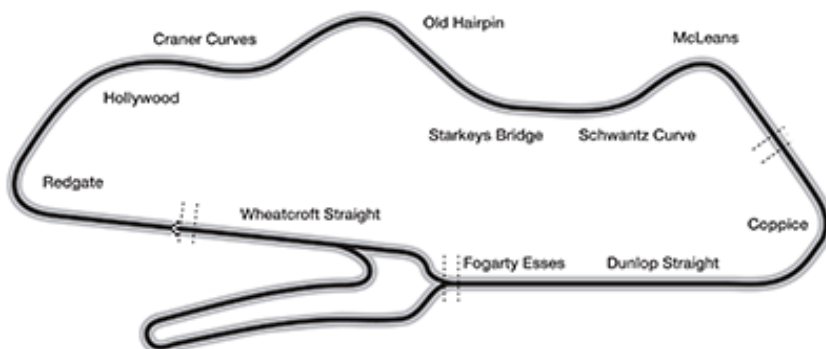

### Donington Circuit lunchtime lappery

Please see details for all members regarding the lunchtime circuit lappery which will be held at the MGCC's race meeting at Donington on Sunday 28<sup>th</sup> August. Please arrange to purchase tickets (£14.00) on the Donington website or on the day at the entrance to the paddock gate. For any members wishing to partake of the lunchtime circuit lappery then please initially park in the register parking and with your personal entrance ticket please enter the paddock and go to the parking

area for the circuit lappery as shown on the plan and sign on with the Z Register representative and collect a vehicle paddock pass and bring your car to that parking area ready to be called forward on to the circuit around 13.00pm. After the lappery please return to that parking area in the paddock.

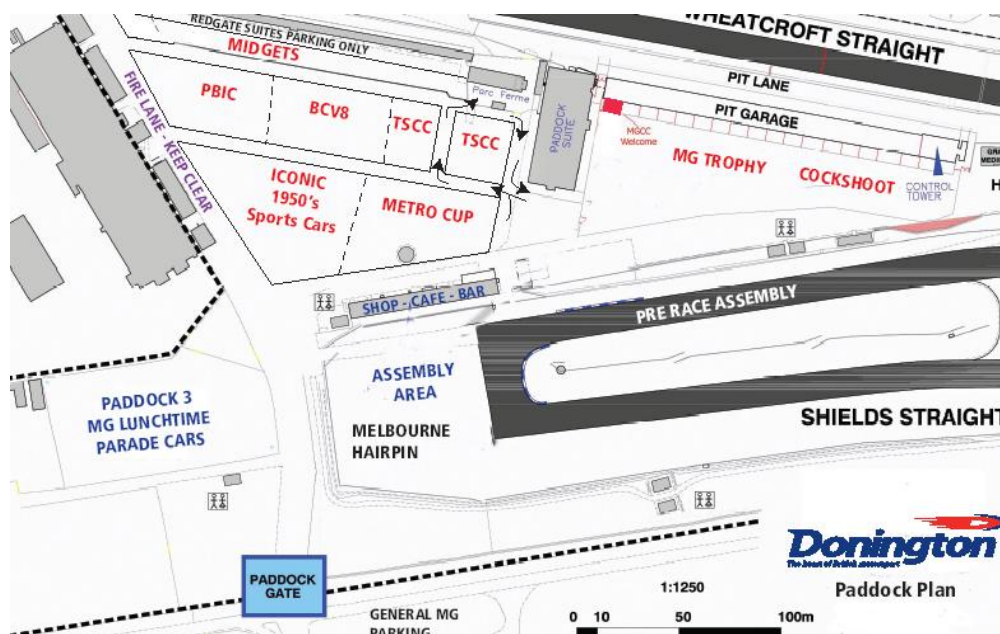

### Register parking

This will be just outside the paddock entrance as shown on the site plan below.

### Timetable

See separate sheet.

### Welcome centre

The Club's usual MG Car Club welcome centre will be available in the paddock in garages 37 & 38 for free coffee and biscuits and all prize giving will take place around 30 minutes after the end of each race.



### How to get to Donington Park

#### From North (M1/A50)

Leave the M1 at junction 24, then at the roundabout take the 4th exit onto the A453 (signposted Tamworth, Birmingham). At roundabout take the 2nd exit onto the A453 (signposted East Midlands Airport, Diseworth, Donington Park).

Go past the Donington Park Service Area (MOTO). At roundabout take the 1st exit onto the A453. At the next roundabout take the 1st exit onto the A453, go past the Airport, and finally turn right into Donington Park.

#### From South (M1/M42/A42)

Leave the M1 at junction 23a, then merge onto the A42 (signposted Stoke A50). At roundabout take the 2nd exit onto the A453 (signposted East Midlands Airport, Diseworth, Donington Park). Go past Donington Park Service Area (MOTO). At the roundabout take the 1st exit onto the A453. At next roundabout take the 1st exit onto the A453, go past the Airport, and finally turn right into Donington Park.

See details online at: <http://www.donington-park.co.uk/pages/contact-donington-park.html>